

# SALLE SANGLIER

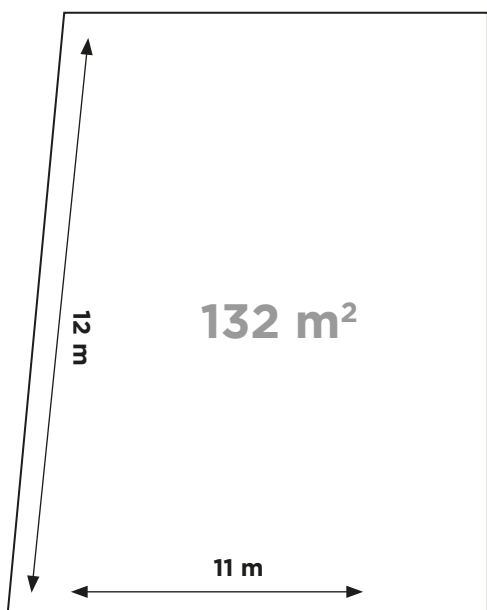

## PLAN DE LA SALLE



## DISPOSITION EN U

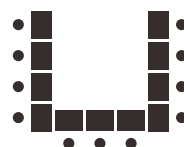

**36 PERS.**

## DISPOSITION ÉCOLE

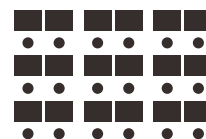

**85 PERS.**

## DISPOSITION THÉÂTRE



**110 PERS.**

## SALLE SANGLIER ( 1/2 )

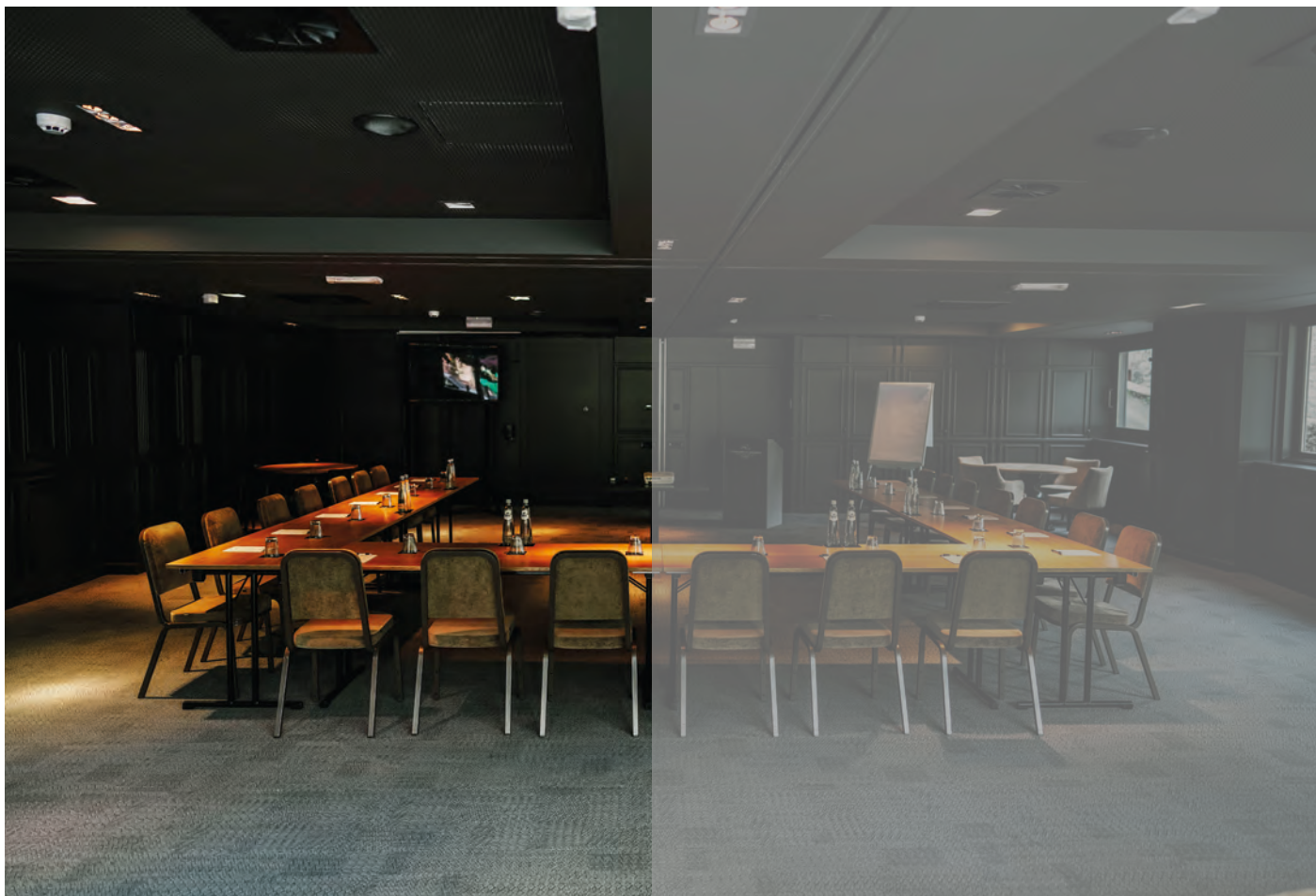

### PLAN DE LA SALLE

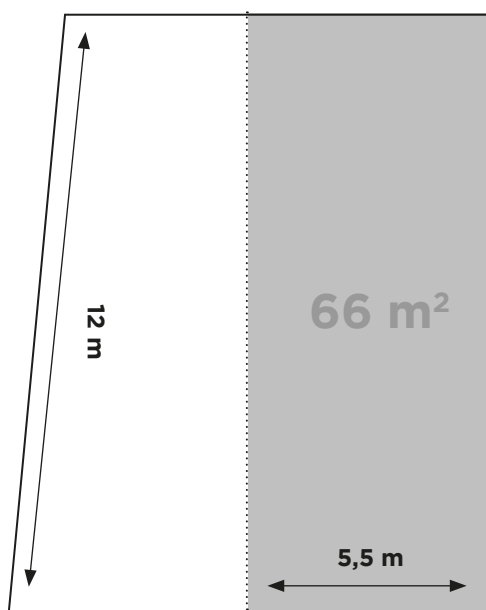

### DISPOSITION EN U



**20 PERS.**

### DISPOSITION ÉCOLE

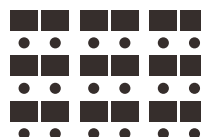

**28 PERS.**

### DISPOSITION THÉÂTRE



**45 PERS.**